



SORELL HOTEL RÜDEN

MEETINGS & EVENTS

SORELL
HOTELS SWITZERLAND



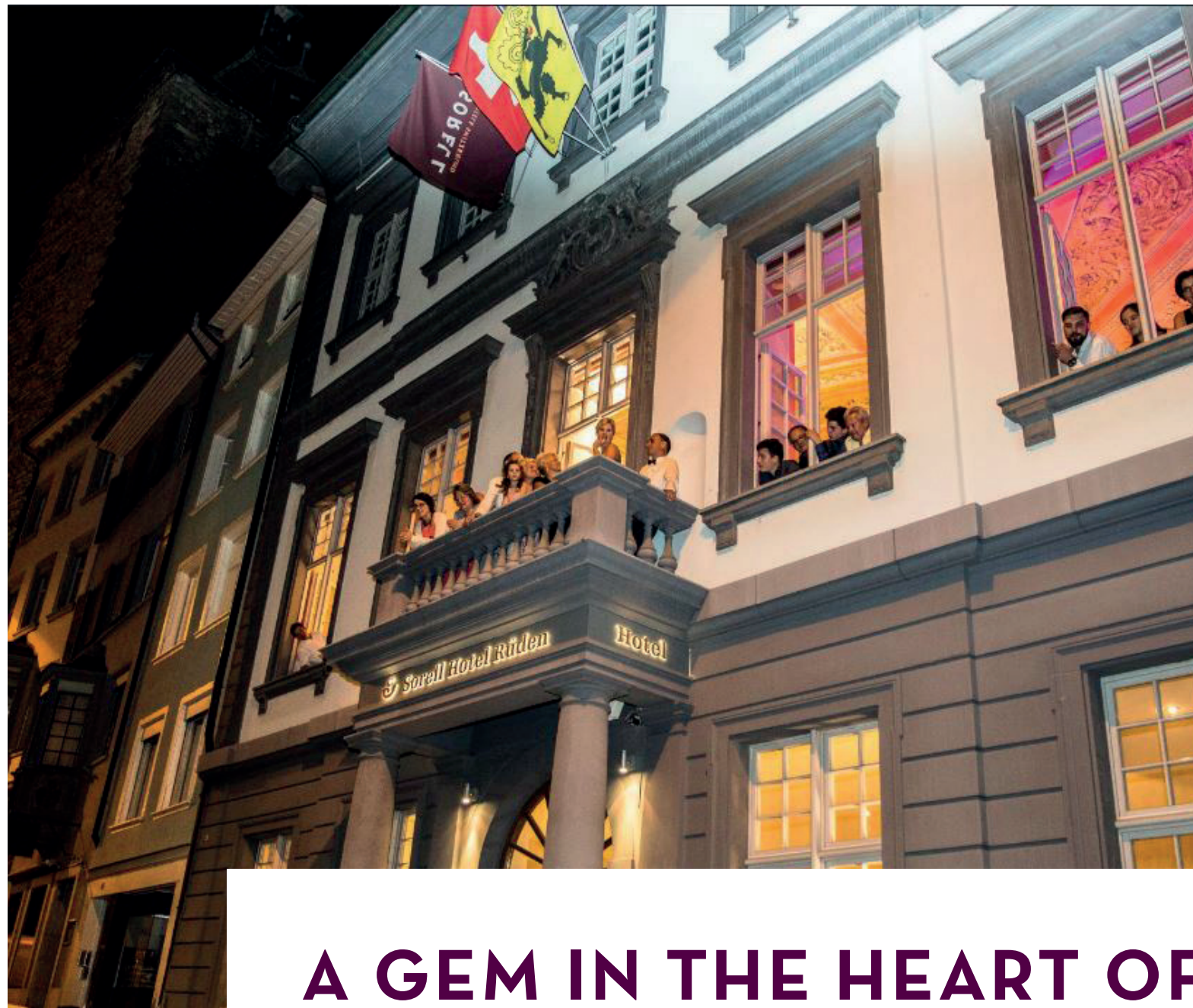

A GEM IN THE HEART OF SCHAFFHAUSEN'S OLD TOWN

From the moment visitors step inside, they are charmed by this chic Schaffhausen hotel, with its original, late 18th century stone wall, antique parquet floors and splashes of contemporary interior design.

Our conference and banqueting rooms are the perfect venue for your meetings, concerts and festivities.



EVENT SPACES



GUILD HALL



GUILD HALL



DOMED ROOM



PLENUM



GUILD HALL



SEMINAR ROOM



GROUP ROOM



MEETING ROOM



SEMINAR ROOM
Size: 29 m²
Height: 2.00 m

Special features: This warm and welcoming room features a beamed ceiling. Measuring 29 square metres, is equipped with a projector and screen. With a ceiling height of 2 metres, it is ideal for team meetings and smaller gatherings.



SEMINAR ROOM
Size: 40 m²
Height: 3.80 m

Special features: Very quiet room facing the internal courtyard. Like most of our rooms, the seminar room has a beautiful, 3.80 m high stucco ceiling.

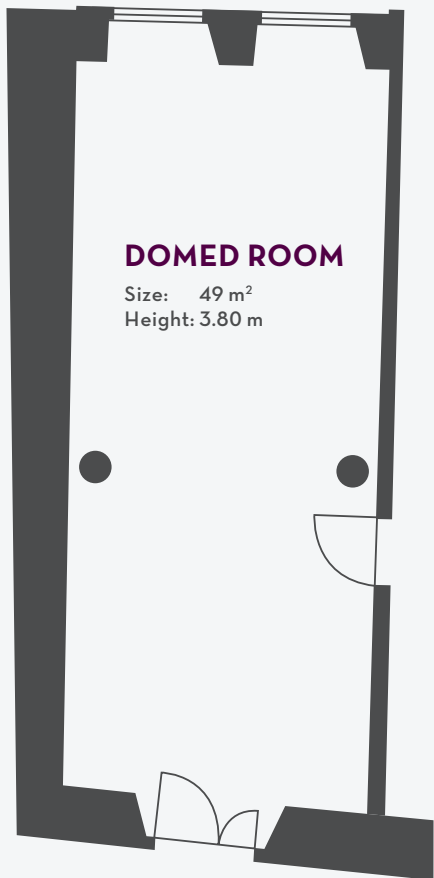

DOMED ROOM
Size: 49 m²
Height: 3.80 m

Special features: This charming room features a domed ceiling and a beautiful parquet floor. The twin columns and cupola on one side make it ideal for events with a two-part programme.

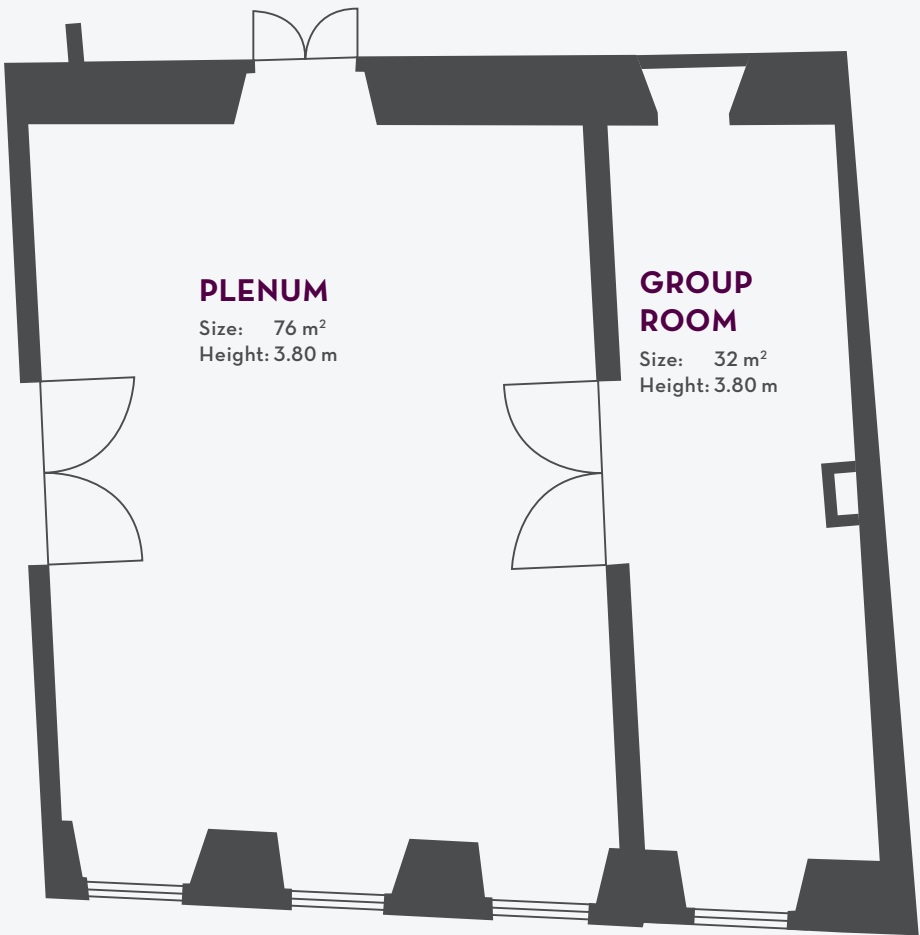

PLENUM
Size: 76 m²
Height: 3.80 m

GROUP ROOM
Size: 32 m²
Height: 3.80 m

Special features: There is a built-in projector and screen in the ceiling for individual use. The Group Room is adjacent to the Plenum Room so the two can be joined together to make a larger space.

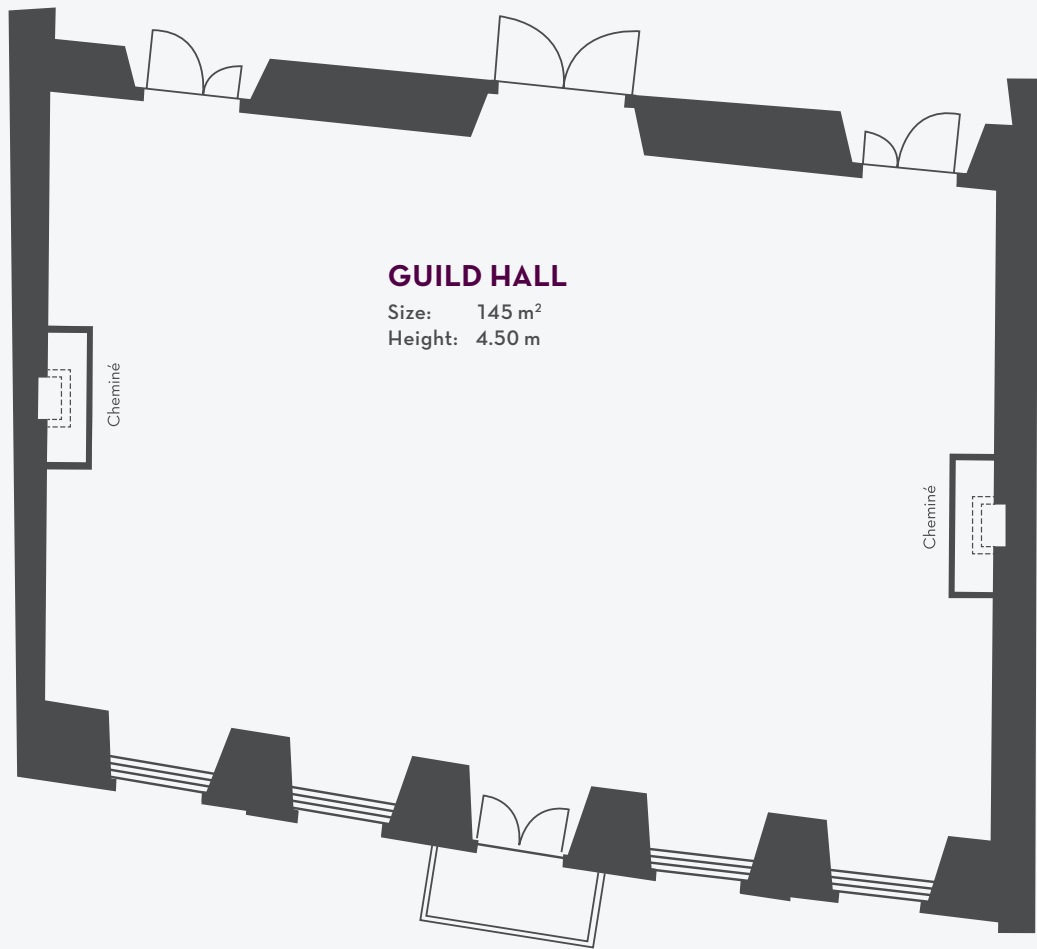

GUILD HALL
Size: 145 m²
Height: 4.50 m

Special features: The glorious Guild Hall is the jewel in the hotel's crown, and an idyllic setting for classical concerts, dreamy weddings and formal banquets.

CAPACITY

Our hotel has six rooms which may be flexibly combined to accommodate up to 200 guests.

The following technical equipment is included as standard with all room rentals

- 1 projector and screen
- 1 flip chart
- 1 whiteboard
- 1 presentation kit
- WiFi
- Pen and paper

	Size m ²	Concert	Classroom	Horseshoe	Boardroom	Banquet
Guild Hall	145	120	60	30	40	99
Domed Room	49	32	12	16	20	30
Plenum Room	76	60	40	24	32	40
Seminar Room	40	40	20	16	20	30
Meeting Room	29	-	-	-	12	-
Group Room	32	30	12	-	12	-

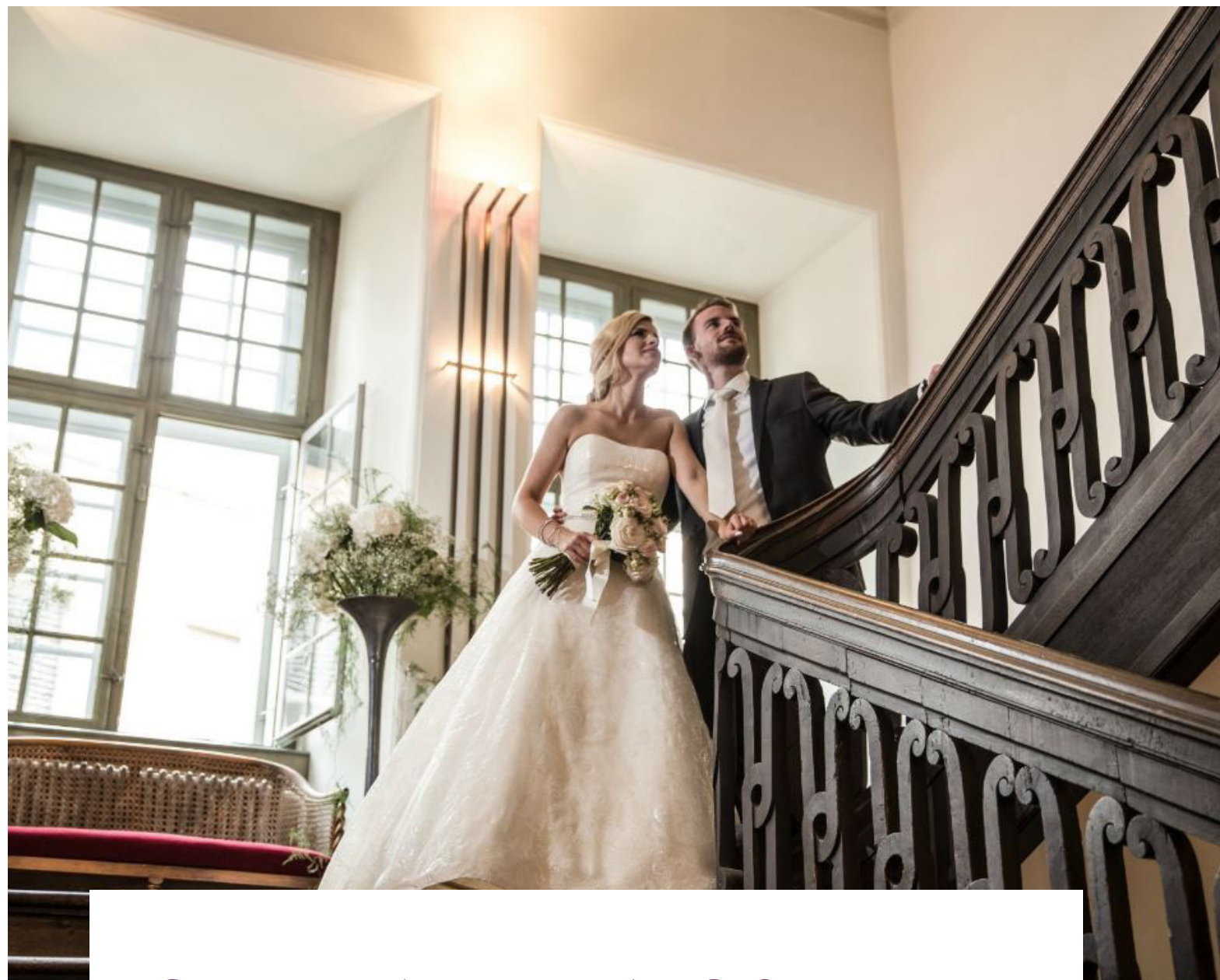

CIVIL WEDDINGS

Whether you are planning a small, intimate civil wedding ceremony or a larger event with up to 110 guests, our Guild Hall is the perfect backdrop for your special day.



For a truly memorable experience, the stunning Guild Hall at Sorell Hotel Rüden is licensed to conduct civil weddings. The beautifully appointed Guild Hall is an idyllic venue for your wedding ceremony, drinks reception and celebration for up to 110 people. Just tell us what you have in mind, and the Sorell Hotel Rüden team will organise a bespoke event and take care of every detail.

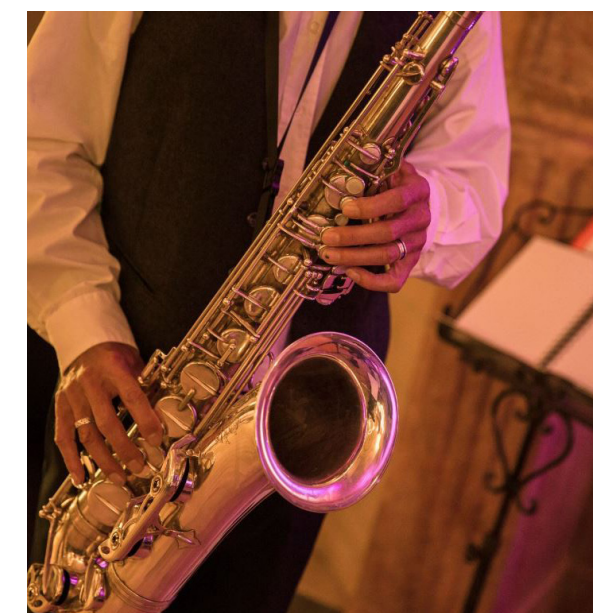

Timings: Civil weddings can be conducted from Wednesday afternoon through to Friday (Saturdays on request).

For bookings, please contact the Schaffhausen registry office directly.

We will be happy to propose a carefully chosen menu and accompanying beverages. Please get in touch to discuss your requirements in person.



SUPERIOR ROOM
22–26 m²



SINGLE ROOM
10–17 m²



ECONOMY ROOM
16–21 m²



STANDARD DOUBLE
12–17 m²

ACCOMMODATION

Our 30 rooms are a stylish combination of historical features such as original stone walls and exposed beams plus high-quality, contemporary furnishings.

For events lasting more than one day, allow us to reserve accommodation for you and your guests.

Get your day off to the perfect start with our generous buffet breakfast.



USEFUL INFORMATION

We have put together some useful information to help you organise your event. Please do not hesitate to contact us with your questions or concerns, and we will do our very best to accommodate your every wish.

Flowers: Please contact your preferred florist directly to discuss your ideas.

Florists Gretener Blumen and Blumenlaube have supplied floral arrangements for many hotel events and come highly recommended by our guests.

Bridal couples: For wedding parties of 50 or more, the bridal couple stays free at the hotel.

Decorations: 5-branch candelabras are available to rent at a cost of CHF 25.00 each.

To comply with local fire regulations, all other decorations and items require pre-approval. The event's organisers will be billed for any damage caused by the attachment of decorations etc.

Birthday and wedding cakes: You are welcome to order cakes or tarts from your favourite patisserie, for which we charge a plating fee of CHF 3.50 per person.

Menus: We will be happy to provide printed menus free of charge. Should you prefer, you can also supply your own printed menus for us to place on the tables.

Music/entertainment: If you are planning to have music at your event, please note that this is generally only permitted until 10.00 pm (later by arrangement only).

Extensions: Extensions: If your banquet continues after midnight, an extension fee will be charged.

Extensions must be agreed with the hotel at least one month in advance. The hotel will secure the required licence at a fixed fee of CHF 250.00. The maximum extension is until 2.00 am.

From midnight onwards, staff costs will be charged at a rate of CHF 50.00 per employee, per hour. The number of staff will vary depending on the size of the event (as a rough guide, 1 employee for every 25 people).

If the event continues beyond the permitted time, a night surcharge is payable.

Ceremonies: We are licensed to perform ceremonies and civil weddings at Sorell Hotel Rüden. Please contact us to discuss your requirements.

Minimum spend: On Fridays and Saturdays in November, December and January, there is a minimum spend of CHF 10'000 in our Zunftsaal (Guild Hall). On all other days, the minimum spend is CHF 8'000.

Cancellation: Where cancellation fees apply and no menu has been chosen, the cancellation fee will be based on a menu price of CHF 70.00 or an aperitif price of CHF 25.00 per person.

The number of guests may be reduced free up charge up until 10 days before the event. After this cut-off date, we will charge 50% of the menu price for each cancelled guest.

Corkage: We can organise just about any wine on your behalf. Should you prefer to bring your own wine with you, corkage will be charged as follows:

Bottle of wine	0.75l	CHF 35.00
Prosecco	0.75L	CHF 40.00
Champagne	0.75L	CHF 40.00
Spirits		CHF 50.00-75.00



THIS CHARMING VENUE

will wow your business partners and guests.

How to find us:

By public transport: By public transport: Schaffhausen main station (HB) is very well-connected with regular services to all major Swiss cities and neighbouring countries. Sorell Hotel Rüden is just 200 metres from the station. Continue along Bahnhofstrasse and turn left into Oberstadt just before the roundabout. Our hotel is on the left.

By car: Please note that we do not have any parking spaces on site and recommend that you park at the nearby Herrenacker Süd car park. (Parkhaus Herrenacker Süd: CHF 20.00 per 24 hours).

From Zurich airport: Zurich-Kloten international airport (ZRH) is 50 kilometres away, one hour by train to Schaffhausen via Winterthur.

Alternatively, we are happy to arrange a shuttle bus or limousine transfer. The journey by car takes around 35 minutes on the A1 and A4 via Winterthur.

MAP

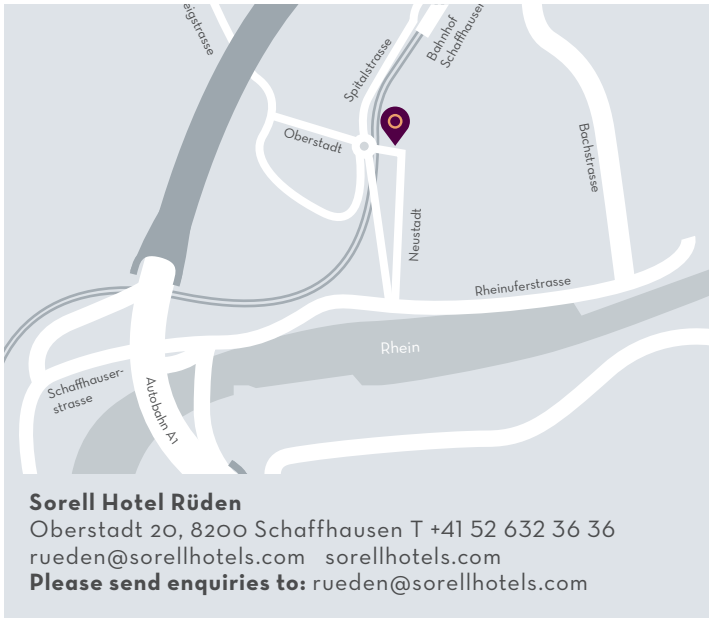

OUR LOCATIONS

Quality hotels with a
 unique ambience
 16 locations in
 Switzerland:

- Zürich
- Bern
- Basel
- Winterthur
- Schaffhausen
- St. Gallen
- Rapperswil
- Bad Ragaz
- Dübendorf

